

ACME-SHOREY

PRECAST CONCRETE PRODUCTS

NOTES:

- 1.) OPTIONAL ITEM FOR LIFTING FOOTING FROST POST #FFP5

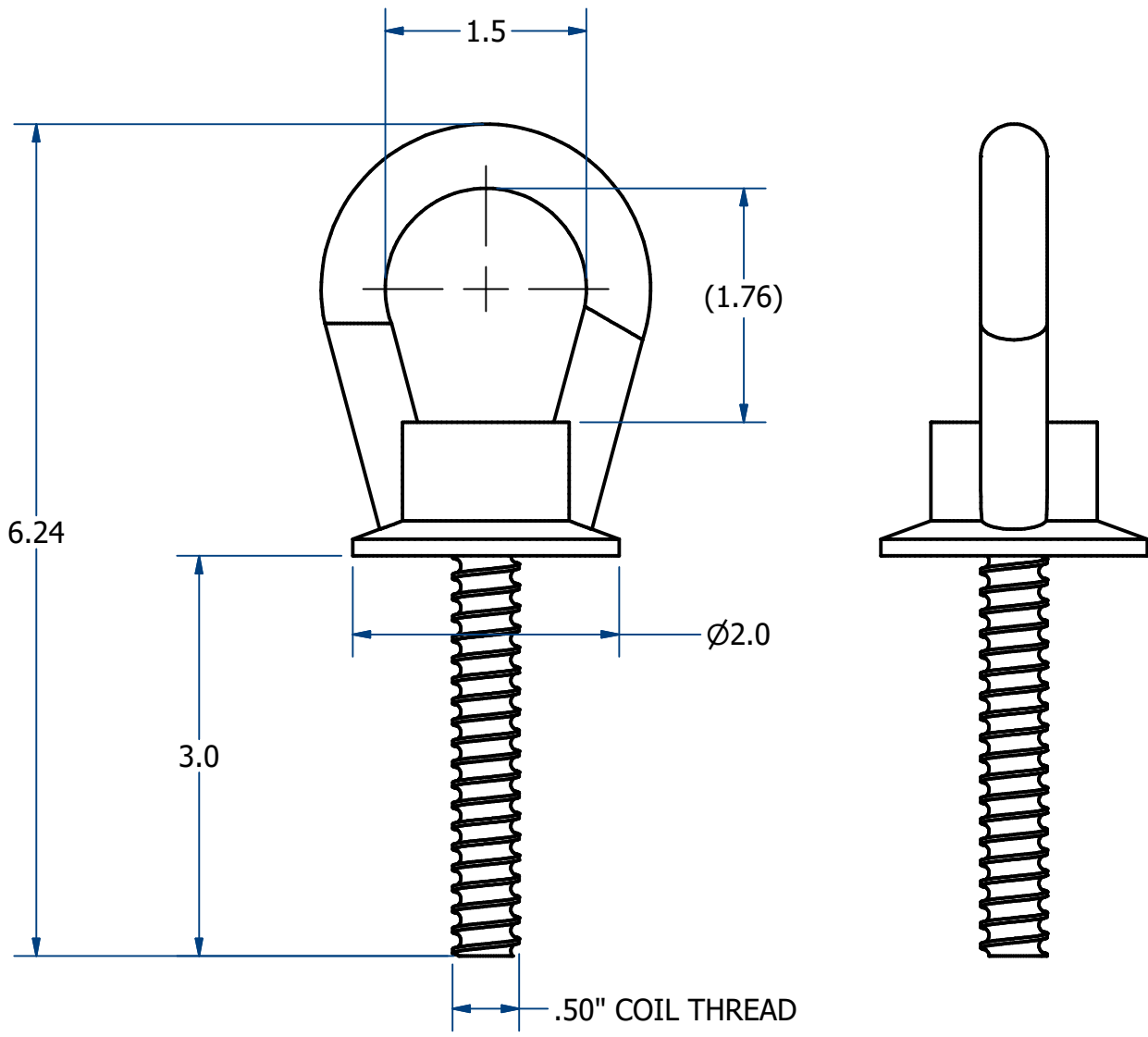

NAME: LIFTING EYE 1/2" COIL THREAD

ITEM# FFPLE.50

Concrete Minimum Strength: 5,000 p.s.i. at 28 days
 Steel Reinforcement: ASTM A615, Grade 60
 Design Loading: standard units - AASHTO - H20

WEIGHT 4 Lbs

CH

DATE: 11-16-20