

NOTES:
1.) DRAINAGE PRODUCT.

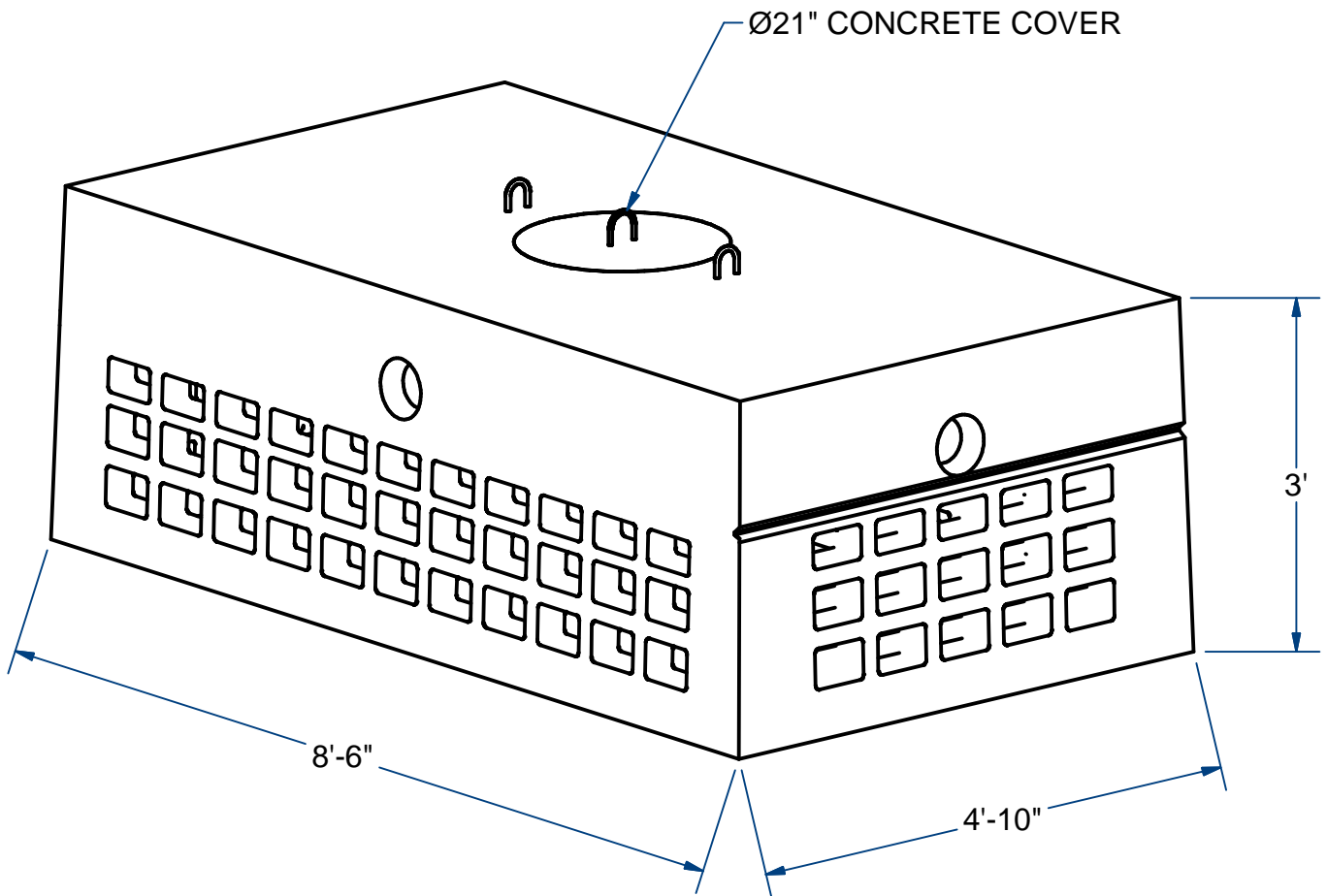

LEACHING CHAMBER, W/(4) 5" K.O.

H20

500 Gallon

ACME-SHOREY

PRECAST CONCRETE PRODUCTS

NOTES:
1.) DRAINAGE PRODUCT.

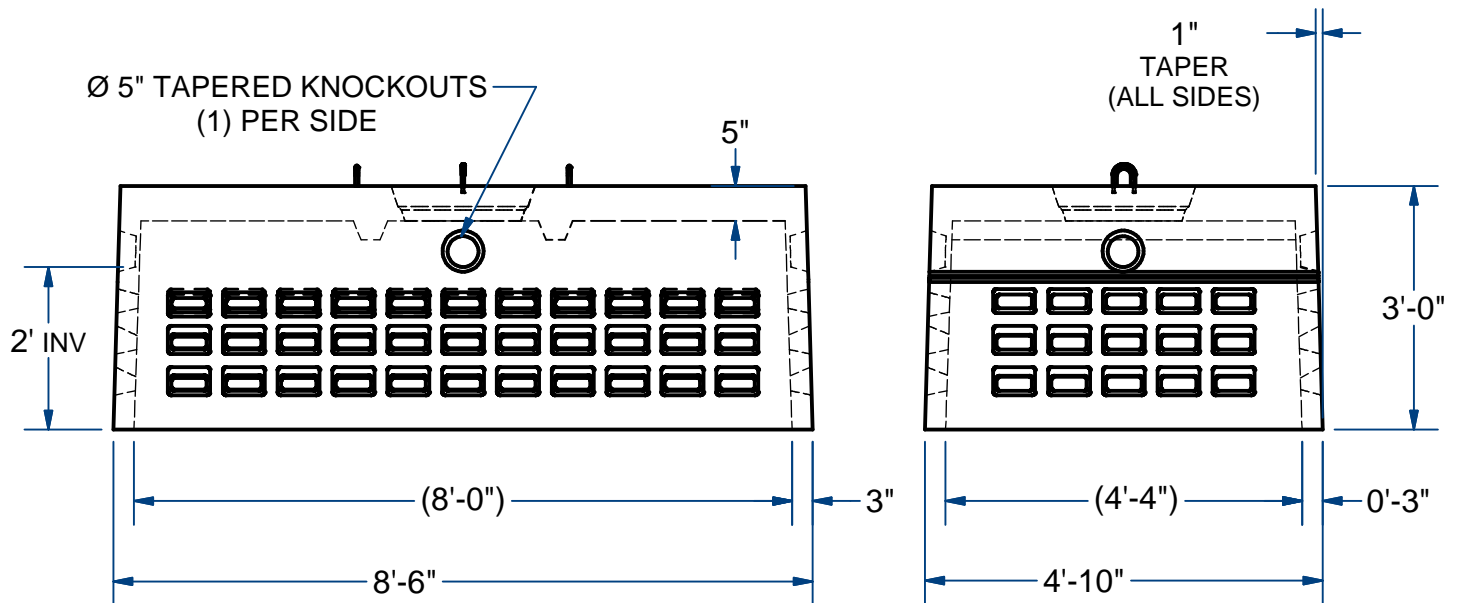
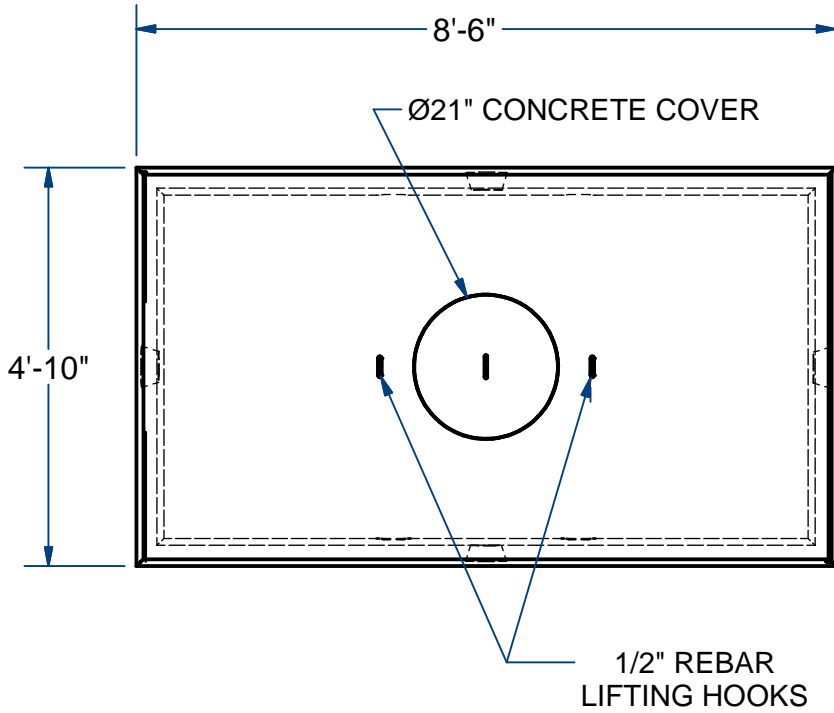

NAME: LEACHING CHAMBER, 500 Gallon

H-20

ITEM# LC52

Concrete Minimum Strength: 5,000 p.s.i. at 28 days
Steel Reinforcement: ASTM A615, Grade 60
Design Loading: standard units - AASHTO - H20

WEIGHT 4,800

Lbs

A

DATE: 4-14-2018

Ch 12 Pg 3.2 Sht 2 of 2