

# ACME-SHOREY

PRECAST CONCRETE PRODUCTS

**NOTES:**

- 1.) RISERS HAVE A TOP GROOVE & BOTTOM LIP TO ALIGN WHEN STACKED.
- 2.) KNOCKOUTS AVAILABLE IN 2',3',& 4' RISERS.

Part#	Description-Risers	O.D.	Height	Invert	Lbs	Sct.	Co.
R30X6	Round Riser, 30" id	38" od	6"	n/a	212	13 - 3.1	S
R30X12	Round Riser, 30" id	38" od	12"	n/a	424	13 - 3.2	S
R30X24	Round Riser, 30" id	38" od	24"	Per Spec	848	13 - 3.3	S
R30X36	Round Riser, 30" id	38" od	36"	Per Spec	1272	13 - 3.4	S
R30X48	Round Riser, 30" id	38" od	48"	Per Spec	1696	13 - 3.5	S

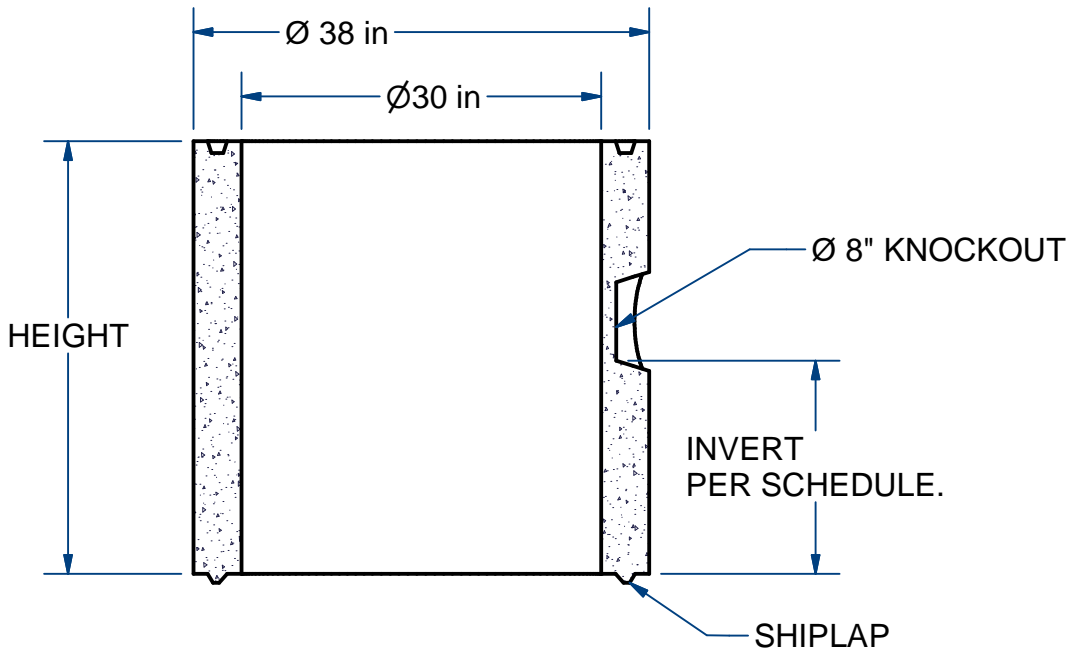
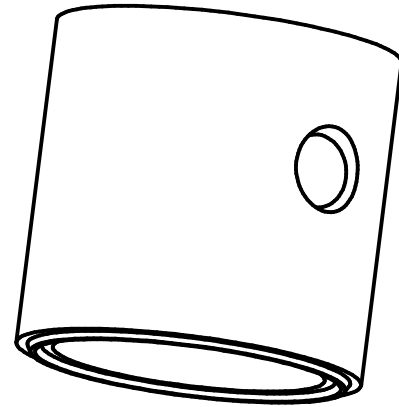
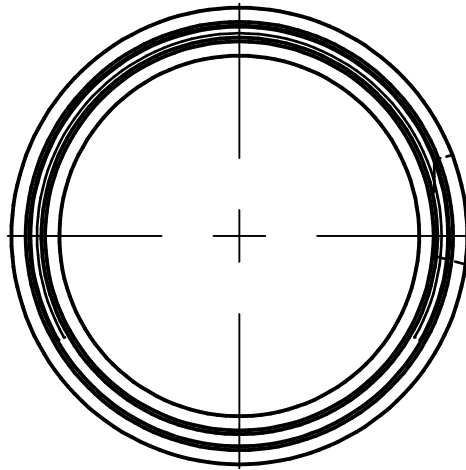

**NAME: ROUND RISERS 30" I.D. x 4" Wall H-20**

**ITEM# R30**

Concrete Minimum Strength: 5,000 p.s.i. at 28 days  
 Steel Reinforcement: ASTM A615, Grade 60  
 Design Loading: standard units - AASHTO - H20

WEIGHT SEE Lbs  
 SCHEDULE

H

DATE: 2-24-22