

ACME-SHOREY

PRECAST CONCRETE PRODUCTS

WWW.ACMESHOREY.COM

PHONE (508) 548-9607

FAX (508) 548-1664

CARVER, MA
334 TREMONT STREET

HARWICH, MA
36 GREAT WESTERN ROAD

NOTES:

- 1.) SEAM SEALED WITH FLEXIBLE BUTYL RUBBER SEALANT.

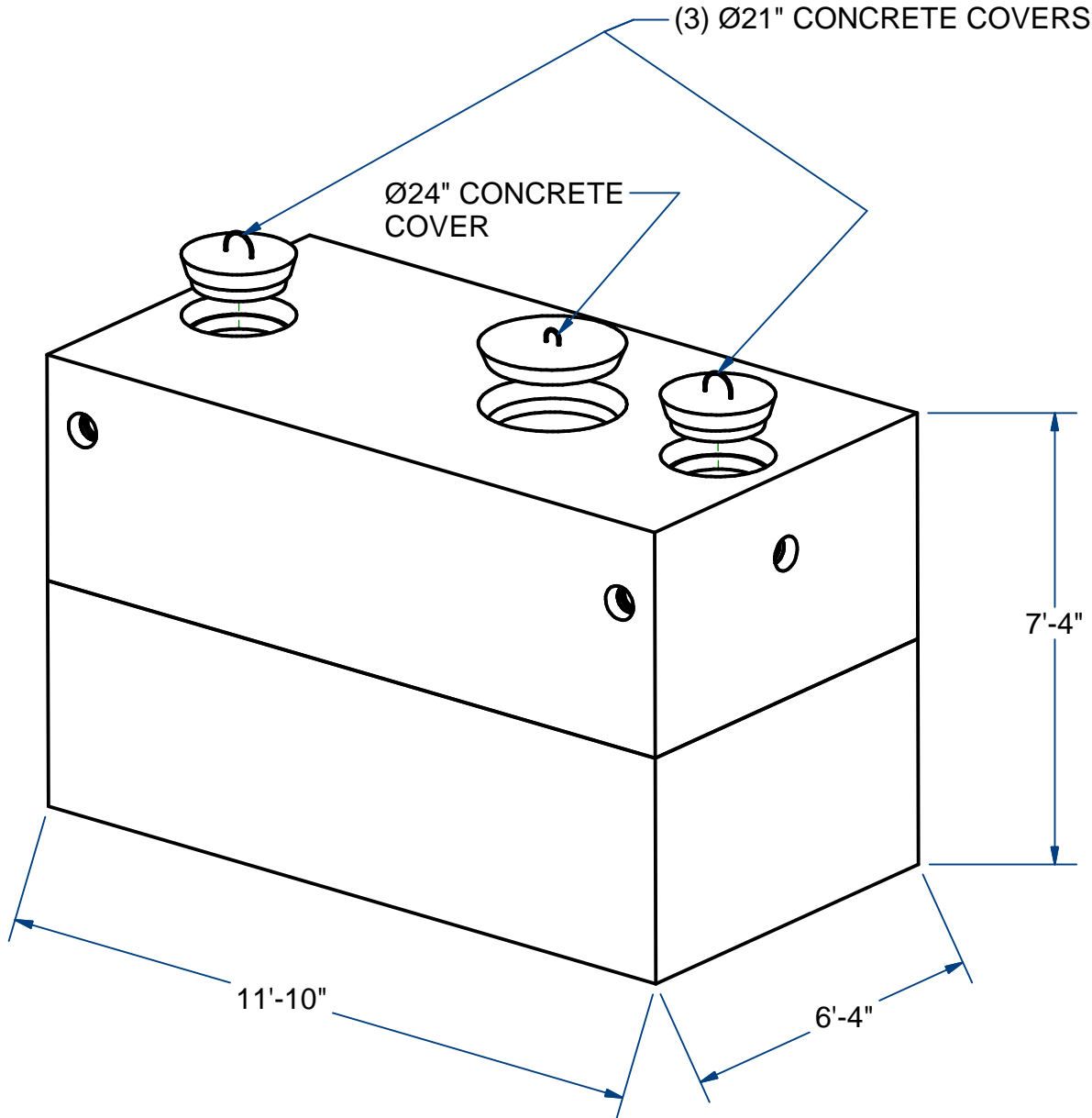

SEPTIC TANK -SEPTIC TANK

H10

2,500 GALLON

ITEM# STST25

Wt. 24,250 Lbs

3 -6.3

Sht 1 of 2

ACME-SHOREY

PRECAST CONCRETE PRODUCTS

NOTES:

- 1.) SEAM SEALED WITH FLEXIBLE BUTYL RUBBER SEALANT.

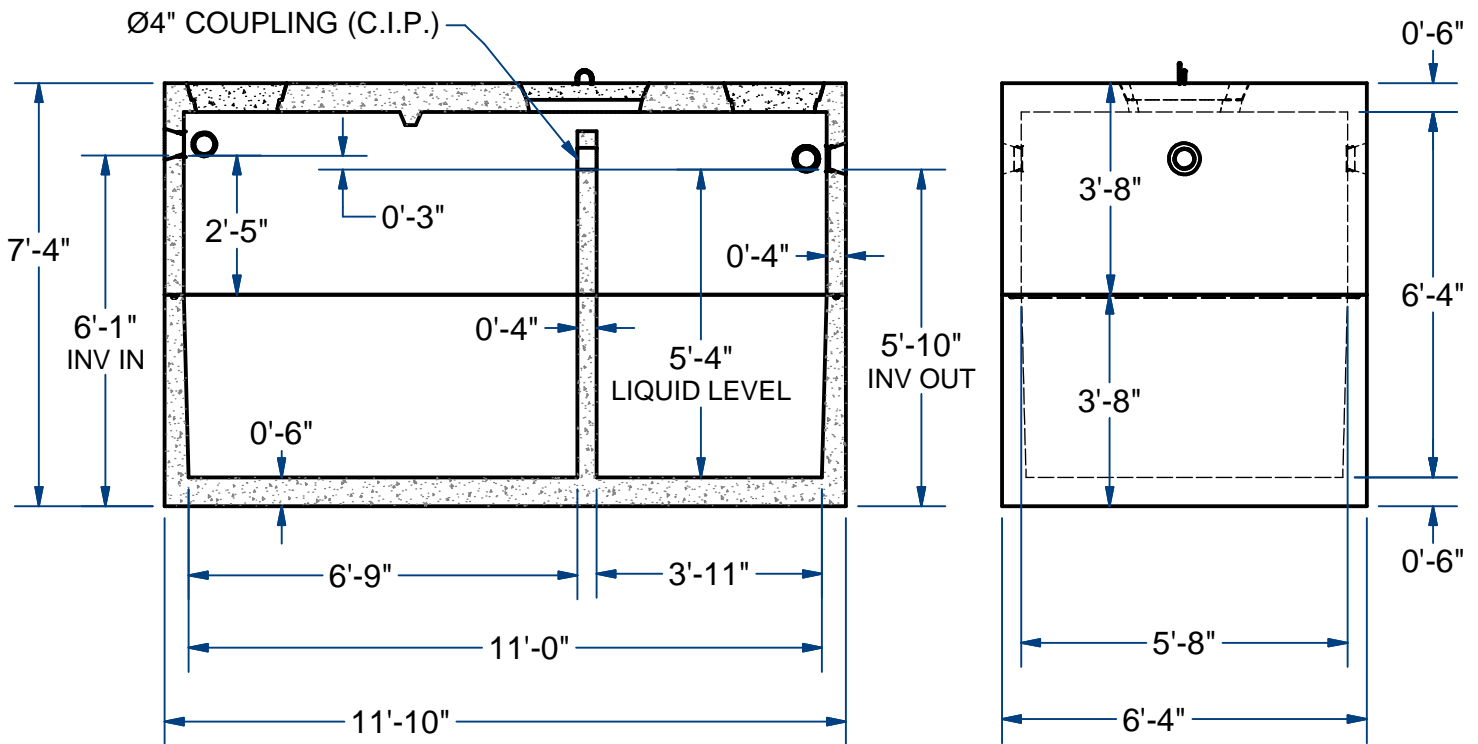
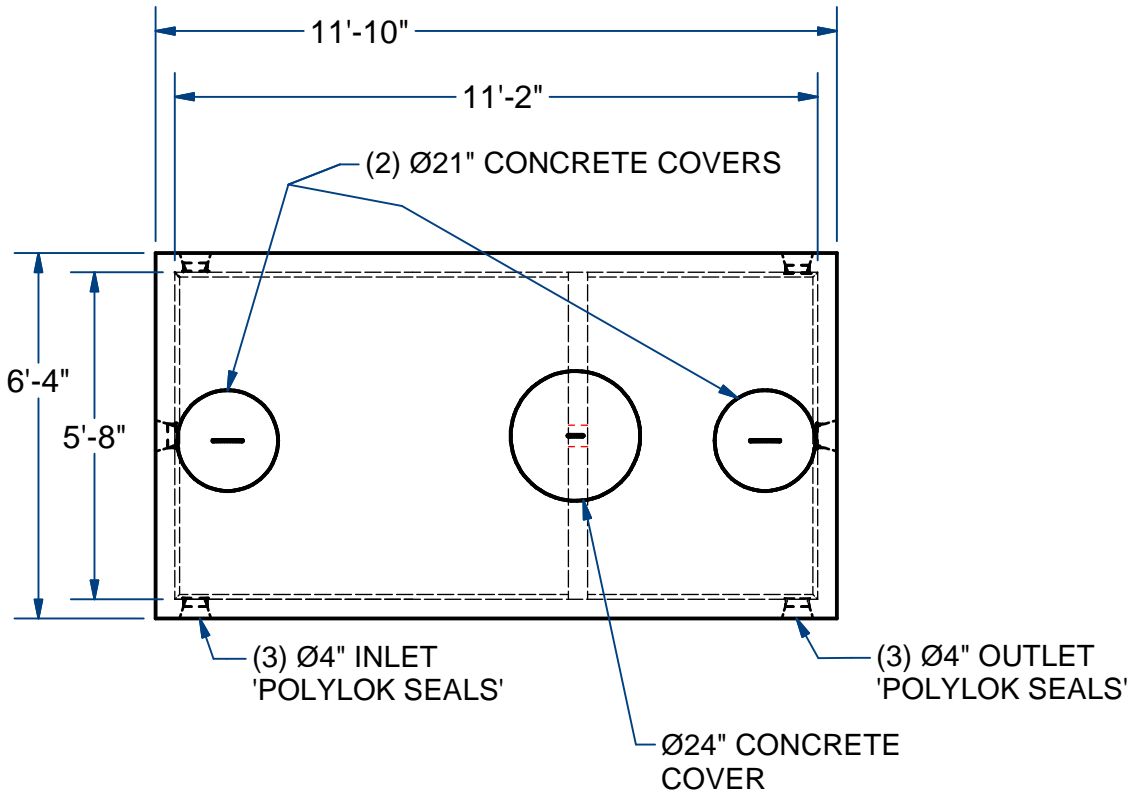

NAME: SEPTIC TANK - SEPTIC TANK, 2500 Gallon H-10

ITEM# STST25

Concrete Minimum Strength: 4,000 p.s.i. at 28 days
 Steel Reinforcement: ASTM A615, Grade 60
 Design Loading: standard units - AASHTO - H10

TOP 11,500 Lbs
 BOTTOM 12,750 Lbs

H

DATE: 3-15-19

Ch 3

Pg 6.3

Sht 2 of 2